

FORM No. 1.

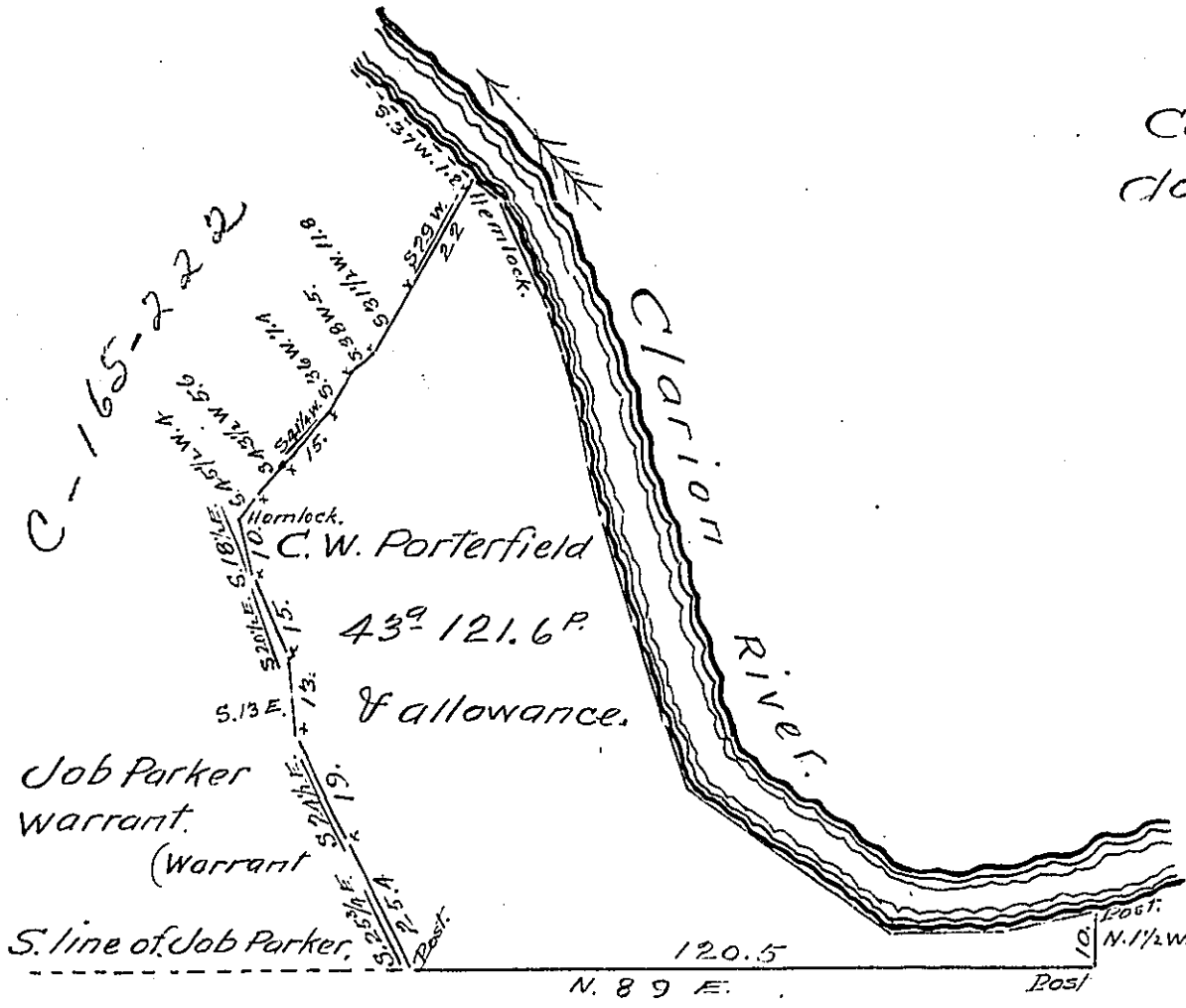

Courses and distances  
down Clarion River

S. 78	W.	16.2	perches.
S. 86 1/2	W.	21.3	"
N. 55	W.	42.	"
N. 20 1/2	W.	12.	"
N. 17 1/4	W.	17.	"
N. 18	W.	20.2	"
N. 10 1/2	W.	7.6	"
N. 9	W.	11.1	"
N. 27	W.	7.2	"
N. 23	W.	8.9	"
N. 26	W.	9.3	"
N. 22 1/2	W.	10.4	"
N. 44	W.	6.1	"

W. Dougherty, improvement.

Surveyed for Charles W. Porterfield on the 21<sup>st</sup>. day of June A.D. 1864 the above described tract of land containing Forty three acres and one hundred and twenty one perches and six tenths of a perch and allowance of six per Cent for Roads &c. Situate on the South side of Clarion River, in the Township of Spring Creek and County of Elk Pa. In the last purchase made of the Indians East of the Allegheny River and Conawango Creek. In pursuance of a warrant granted to C. W. Porterfield, dated at Harrisburg the 22<sup>nd</sup>. day of February A.D. 1864 Calling for 40 acres, unimproved.

To James P. Barr Esq.  
Surveyor General.

George Walmsley  
Surveyor for Elk County.

IN TESTIMONY that the above is a copy of the original remaining on file in the Department of Internal Affairs of Pennsylvania, made conformably to an Act of Assembly approved the 16th day of February, 1833, I have hereunto set my Hand and caused the Seal of said Department to be affixed at Harrisburg, this second day of August 1906.

*Loacn P. Brown*  
Secretary of Internal Affairs.